

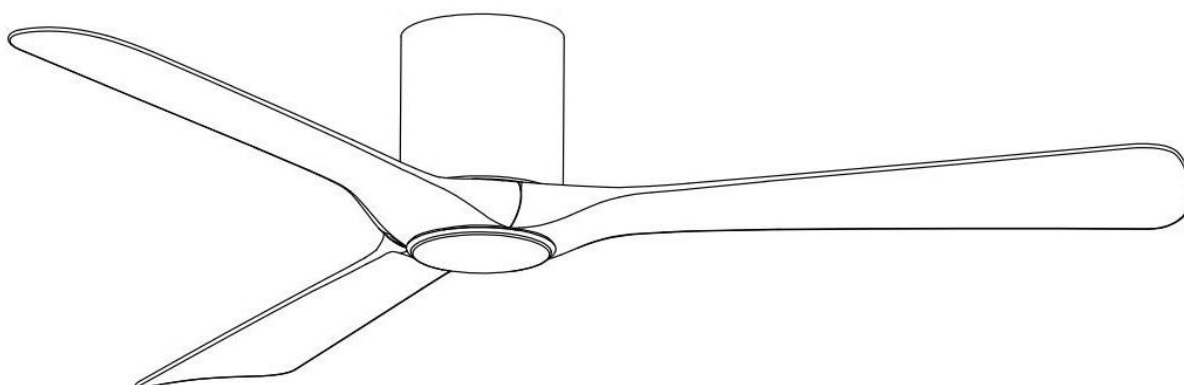

01417

CODE	Color
610-01417-20-01	Black
610-01417-20-02	White

Ceiling Fan Installation & Operation Manual



Note: Disassembly only by the professionals.

(The actual functions and appearance of the product may differ from this manual.
Information may be changed without notice.)

Please read this manual carefully before using. Take good care of the manual.

230V~50Hz



WARNINGS

- Read entire booklet carefully before beginning installation and save these instructions.
- To reduce the risk of personal injury, attach the fan directly to the support structure of the building according to these instructions, and use only the hardware supplied.
- To avoid possible electrical shock, before installing your fan, disconnect the power by turning off the circuit breakers to the outlet box and associated wall switch location.
- All wiring must be in accordance with national and local electrical codes. If you are unfamiliar with wiring, you should use a qualified electrician.
- To reduce the risk of personal injury, do not bend the blade attachment the system when installing, balancing or cleaning the fan. Never insert foreign objects between rotating fan blades.
- To reduce the risk of fire, electrical shock or motor damage, do not lift or carry the fan by the lead wires.
- Ensure that when mounting the ceiling fan that the fixing can support the moving weight of the fan which is 15.8kg(35lb) minimum.
- The fan blades cannot be installed lower than 2.3m from the floor.

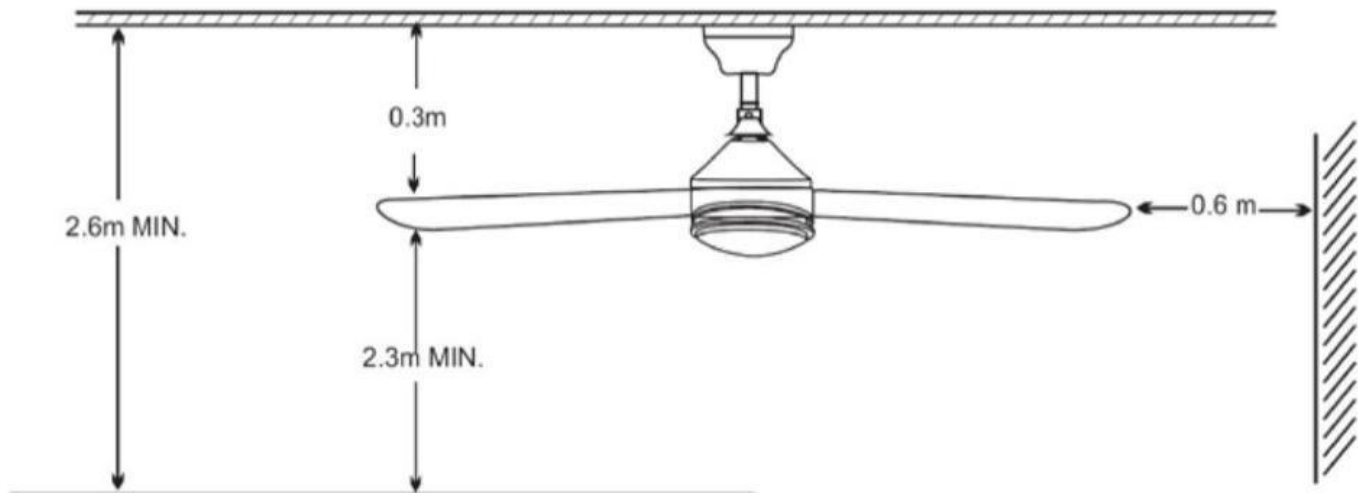

TOOLS REQUIRED

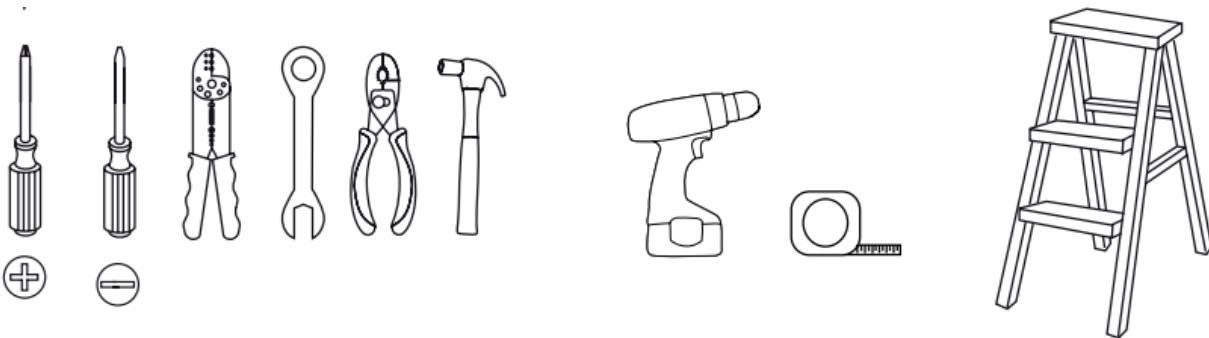

Be sure to turn off the power before preparing for installation



PACKAGE CONTENTS

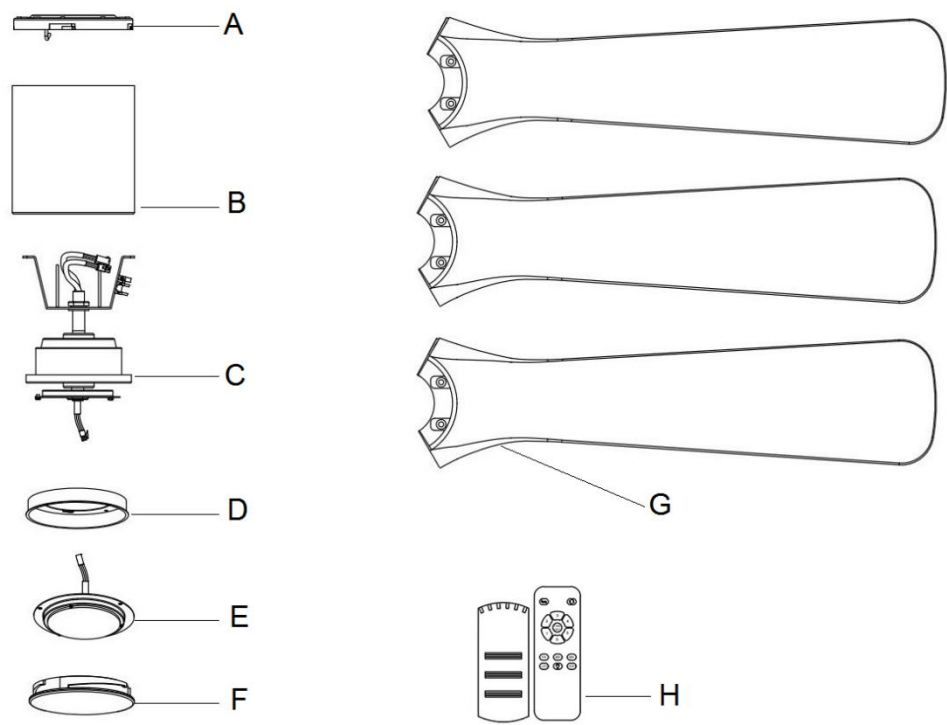

Part	Description	Quantity
A	Slide-in mounting bracket tray	1
B	Fan-motor assembly	1
C	Fan motor enclosure	1
D	light kit pan	1
E	LED light kit	1
F	Glass bowl	1
G	Blade	3
H	Remote control	1

HARDWARE INCLUDED (NOTE: Hardware not shown to actual size)

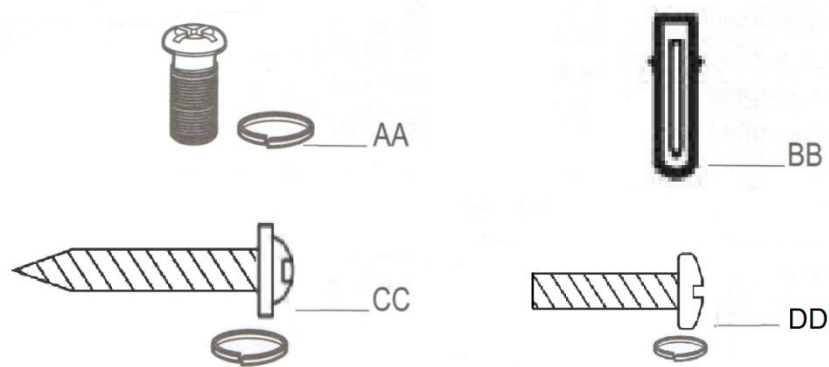

Part	Description	Quantity
AA	Blade attachment screws	1
BB	Explosive expansion joint	4
CC	Wood screw	4
DD	Box Mounting screws	2

PREPARING FOR MOUNTING

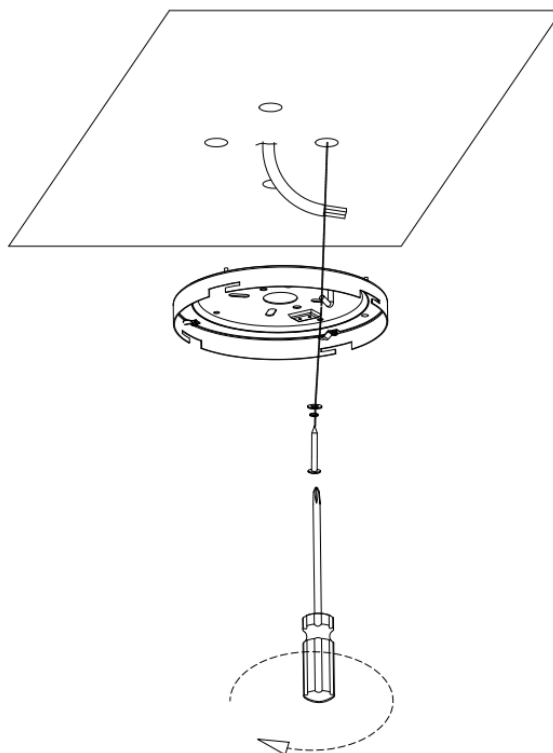
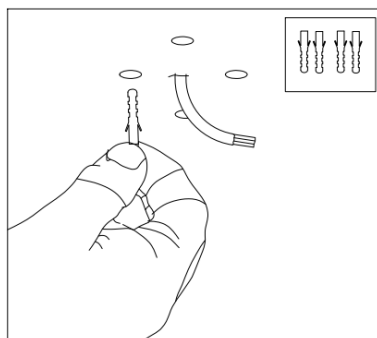
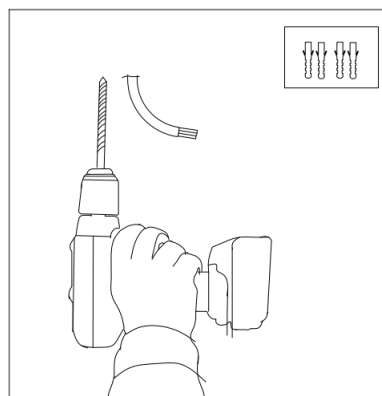

1. install the Slide-in mounting bracket tray to the ceiling. (please ensure the fixing is able to support minimum moving weight of the fan which is 15.8kg=35Lb)

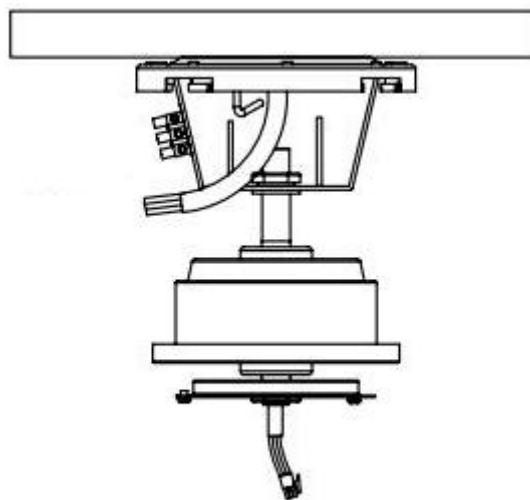
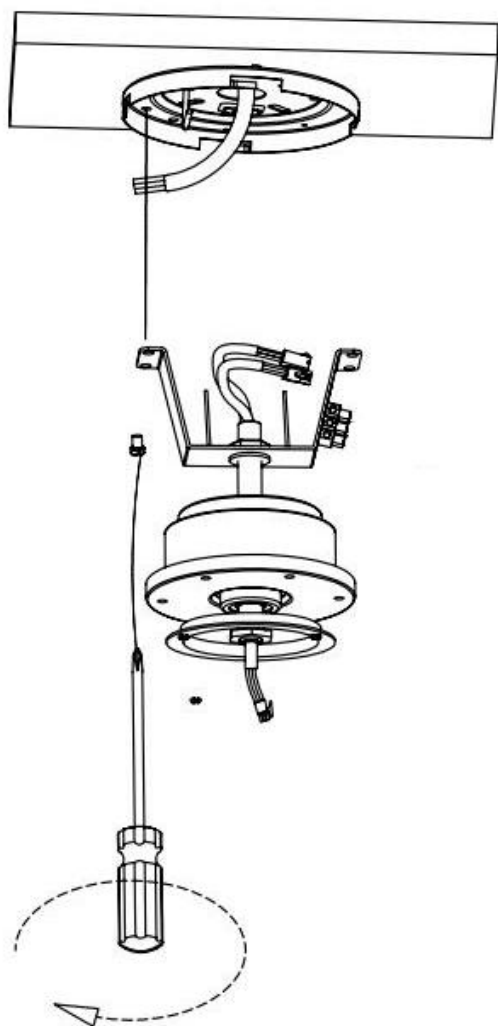

2. Carefully lift the fan-motor assembly up to the Slide-in mounting bracket tray. Install the fan-motor assembly using the 4 mounting screws on the slide-in mounting bracket tray.

power supply from ceiling (230V/50Hz)

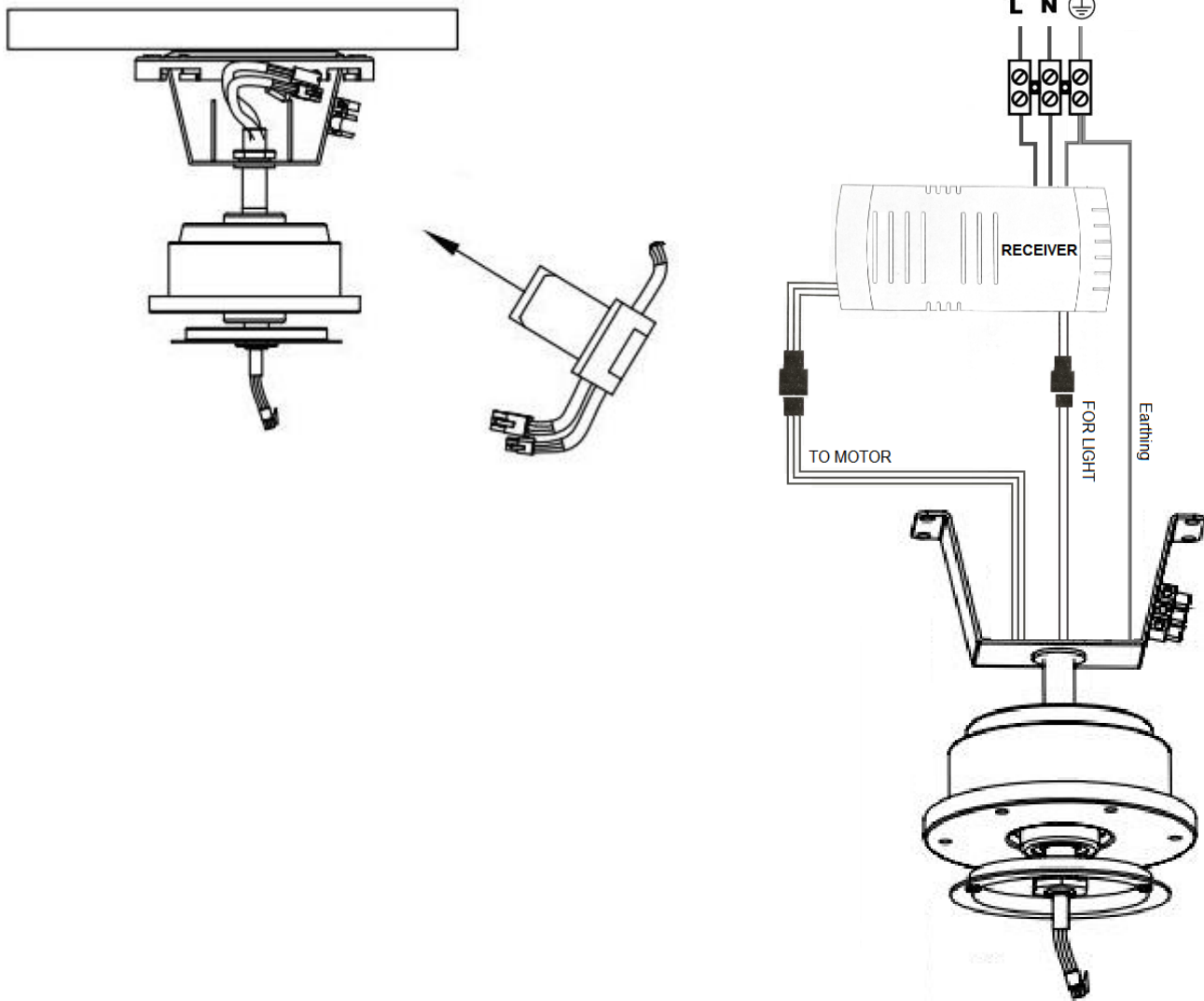

3. Set up the remote receiver on the motor U-frame. Wiring according to remote control wiring diagram.

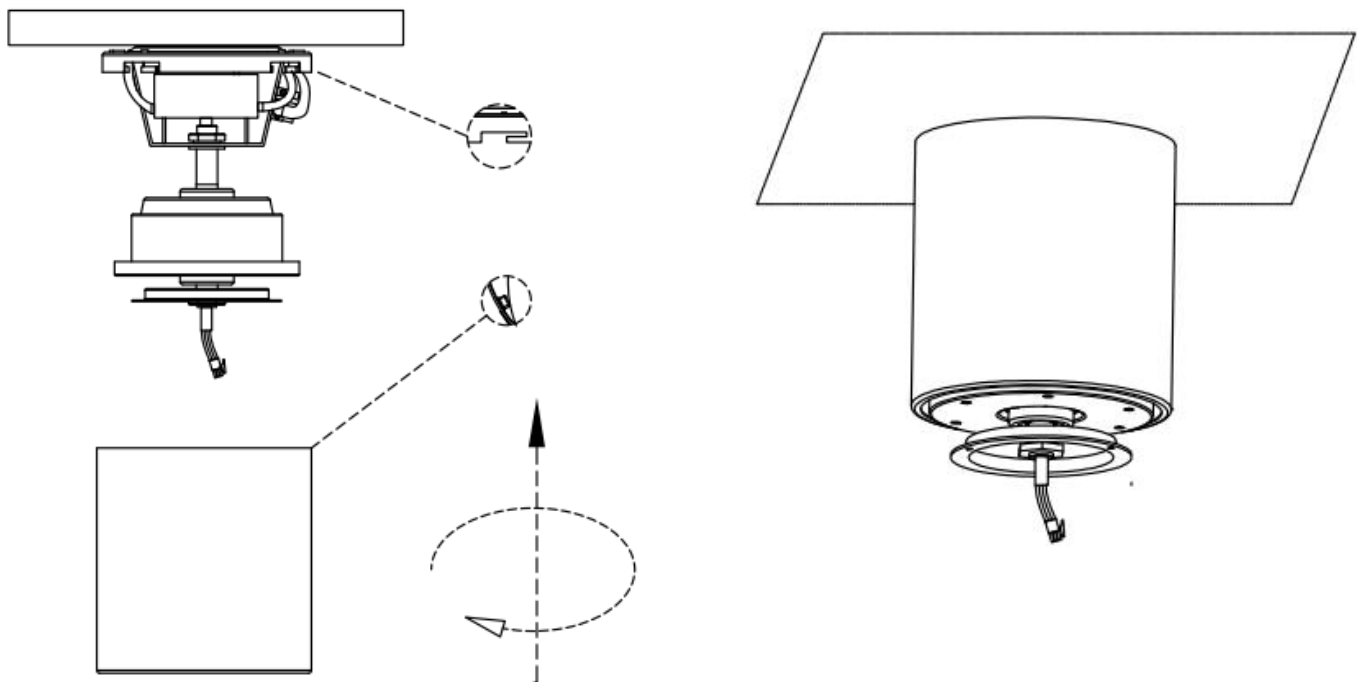

4. Carefully fit the Fan motor enclosure into the motor assembly and align the locking slots of the Fan motor enclosure with the four locking slots on the mounting support tray. Push upward into the locking slot and turn clockwise to lock into place.

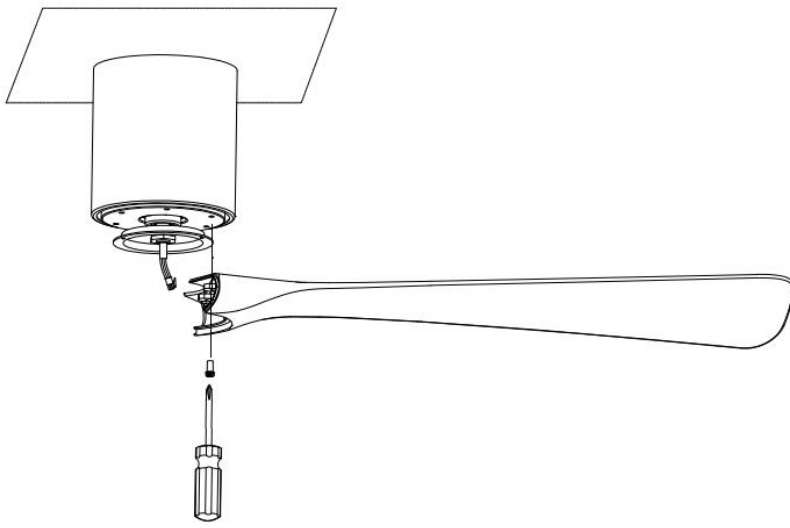

5. Fasten the blade to the fan-motor assembly by the blade bracket screws.

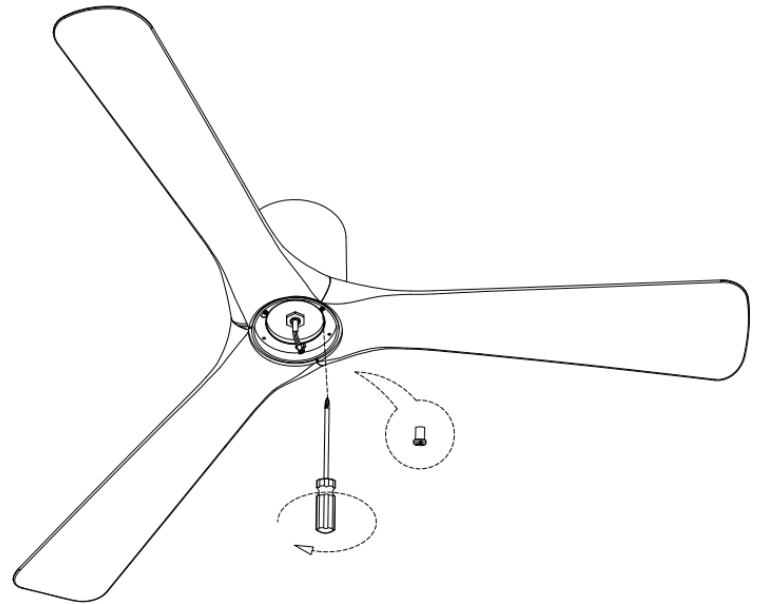
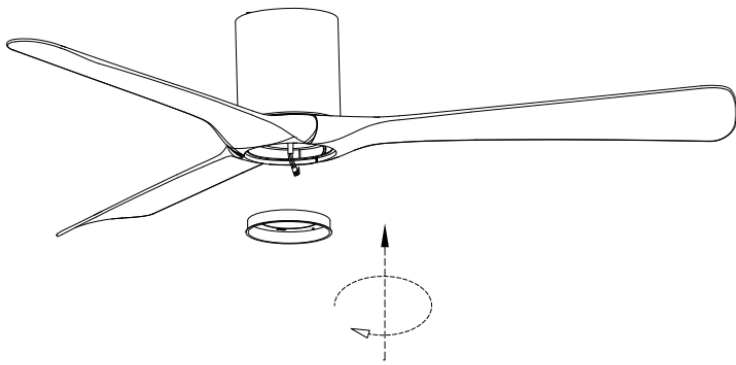

6. Remove the three screws from the fan - motor assembly. Align the three holes in the light kit pan. Make sure the notch in the light kit pan. Position the light kit pan and re-install the three screws that were removed in the first step to secure the light kit pan.

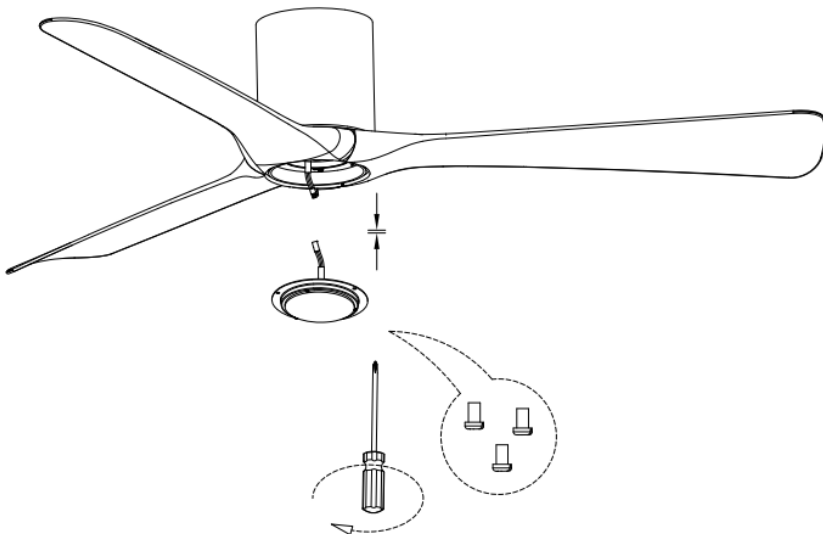

7. Connect the 2-pin plug exiting the bottom of the fan motor to the 2-pin plug from the LED light kit pan. Secure the LED light kit in the light kit pan .

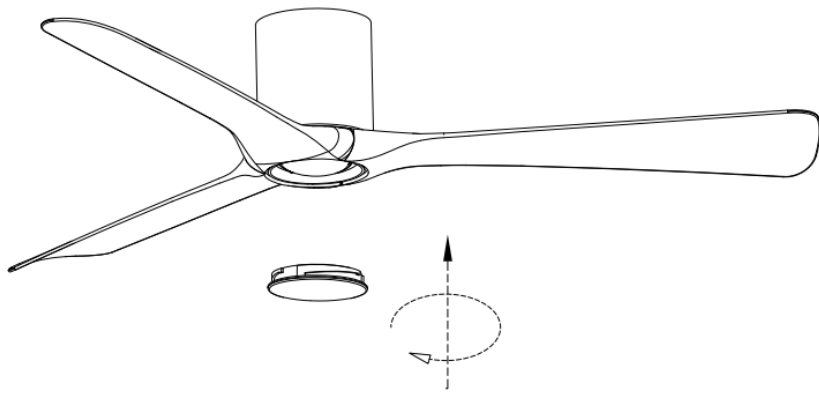

8. Place the glass bowl into the light kit pan . Turn the glass bowl clockwise until it stops.

OPERATING YOUR FAN

Turn on the power and check the operation of the fan.

Functions of Transmitter

1. LED light indicator.
2. Fan OFF button.
3. Light ON/OFF
4. LED brightness decreases
5. Natural Wind(Fan speed repeat cycle from 1 to 6)
6. Speed control button:
 - . Speed 1 (Slowest)
 - . Speed 2
 - . Speed 3
 - . Speed 4
 - . Speed 5
 - . Speed 6 (Fastest)
7. Forward/Reverse switch.
8. Timer button:1h、4h、8h
9. LED brightness adjustment

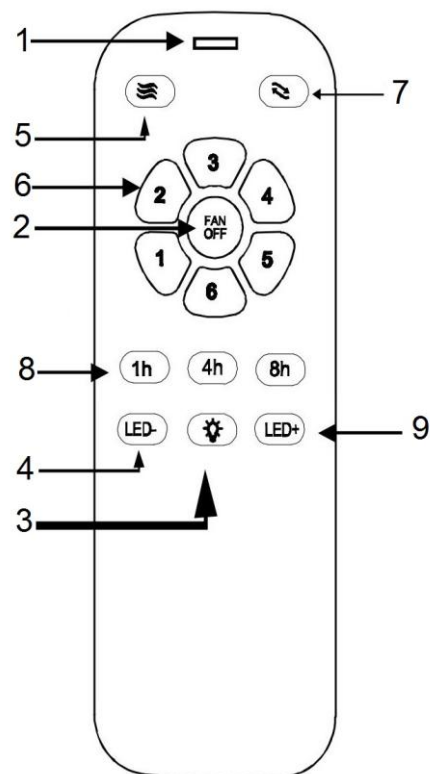

IMPORTANTE

1. When the transmitter cannot control the receiver, please check whether the battery switch contact is normal, whether the positive and negative poles are placed correctly, and whether the battery is sufficient. If the battery voltage is too low, it will affect the transmitting intensity and cause remote control failure. Please replace the battery in time.
2. When the transmitter cannot control the receiver, please check if there are similar products nearby. The simultaneous transmission of radio waves by the same kind remote control products will cause interference to each other and affect the receiving effect.
3. The battery will decrease in power over time. Please replace the battery before it leaks to avoid damage to the transmitter. Please handle the used battery properly. Keep the battery out of the reach of children.
4. If you do not use it for a long time, please remove the batteries from the transmitter.

Care and Cleaning



WARNING: Make sure the power is off before cleaning your fan.

- ☐ Because of the fan’s natural movement, some connections may become loose. Check the support connections, brackets, and blade attachments twice a year. Make sure they are secure. It is not necessary to remove the fan from the ceiling.
- ☐ Clean your fan periodically to help maintain its new appearance over the years. Do not use water when cleaning, as this could damage the motor, or the wood, or possibly cause an electrical shock. Use only a soft brush or lint-free cloth to avoid scratching the finish. The plating is sealed with a lacquer to minimize discoloration or tarnishing.
- ☐ You can apply a light coat of furniture polish to the wood for additional protection and enhanced beauty. Cover small scratches with a light application of shoe polish.
- ☐ You do not need to oil your fan. The motor has permanently-lubricated sealed ball bearings.

Troubleshooting

Problem	Solution
The fan will not start.	<ul style="list-style-type: none"><input type="checkbox"/> Check the main and branch circuit fuses or breakers.<input type="checkbox"/> Check the line wire connections to the fan and switch wire connections in the switch housing.
The fan is noisy.	<ul style="list-style-type: none"><input type="checkbox"/> Ensure all motor housing screws are snug.<input type="checkbox"/> Ensure the screws that attach the blade bracket to the motor hub are tight.<input type="checkbox"/> Ensure the wire nut connections are not rattling against each other or the interior wall of the switch housing.<input type="checkbox"/> Allow a 24-hour “breaking in” period. Most noises associated with a new fan disappear during this time.<input type="checkbox"/> If you are using the Ceiling Fan light kit, ensure the screws securing the glassware are tight. Check that the light bulbs are also secure.<input type="checkbox"/> Ensure the canopy is a short distance from the ceiling. It should not touch the ceiling.<input type="checkbox"/> Ensure your outlet box is secure and rubber isolator pads were used between the mounting plate and outlet box.
The fan wobbles.	<ul style="list-style-type: none"><input type="checkbox"/> Check that all blade and blade arm screws are secure.<input type="checkbox"/> Most fan wobble problems are caused when blade levels are unequal. Check this level by selecting a point on the ceiling above the tip of one of the blades. Measure from a point on the center of the blade to the point on the ceiling. Rotate the fan until the next blade is positioned for measurement, and measure from the same point on each blade to the ceiling. Repeat for each blade. Any measurement deviation should be within 1/8 in. Run the fan for ten minutes. If the fan continues to wobble please contact Customer Service and a balancing kit will be sent to you at no charge.